

This document, together with the concepts and designs presented herein, is intended only for the specific purpose and client for which it was prepared. Reuse of and improper reliance on this document without written authorization and adaptation by Kinney-Horn and Associates, Inc. shall be without liability to Kinney-Horn and Associates, Inc.

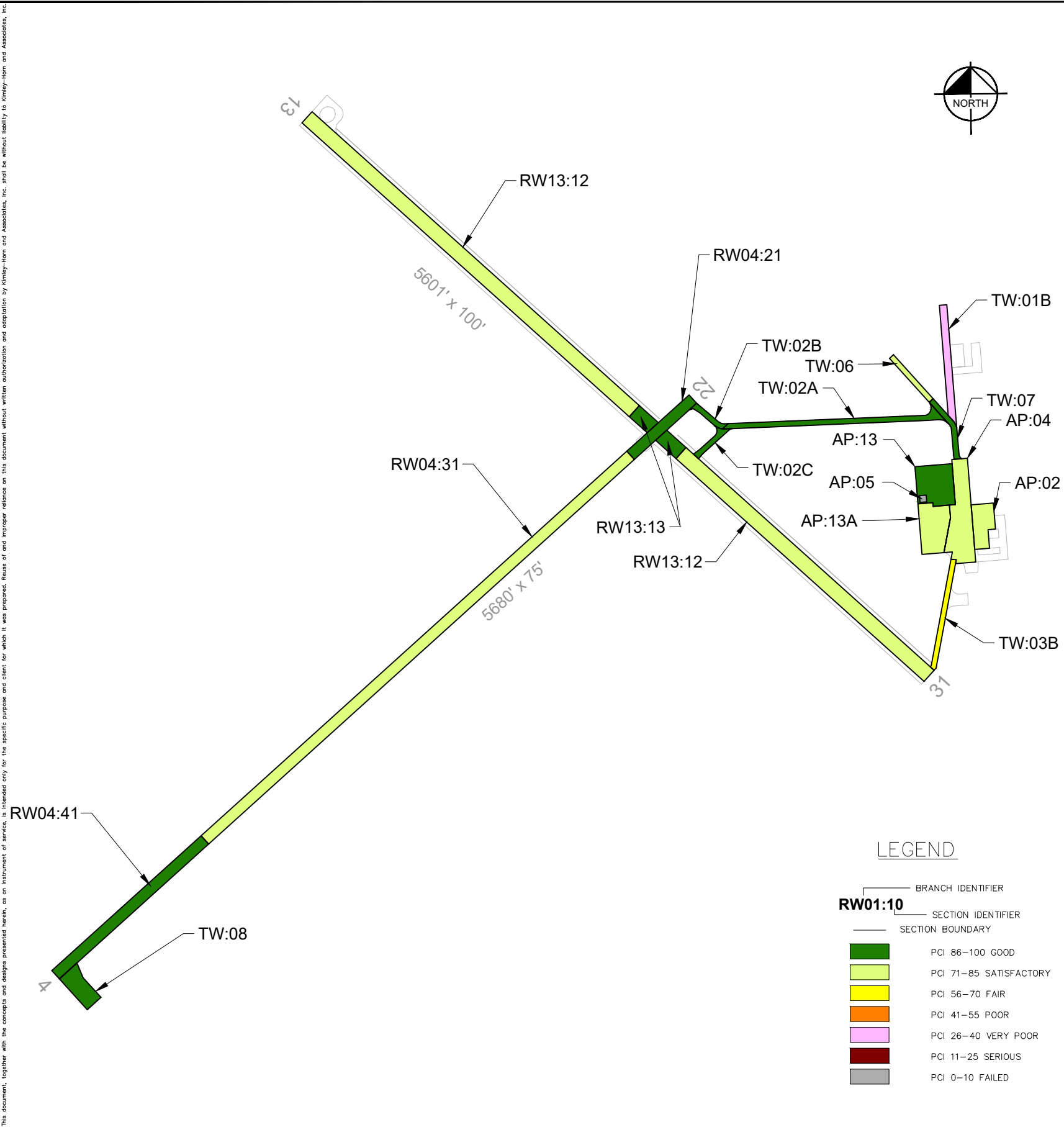

CURRENT 2024 PAVEMENT CONDITION INDEX

Branch ID	Section ID	Branch Name	Surface Type	Section Area (SF)	Approx. Age at Inspection	Last Major Work Date	Last Inspection Date	Pavement Condition Index	PCI Category
RW04	21	Runway 04-22	AAC	42,225	3.9	1/5/2021	10/14/2024	94	Good
RW04	31	Runway 04-22	AC	288,750	9	11/6/2015	10/14/2024	81	Satisfactory
RW04	41	Runway 04-22	AC	101,250	3.9	1/1/2021	10/14/2024	94	Good
RW13	12	Runway 13-31	AAC	518,902	16.3	8/1/2008	10/14/2024	73	Satisfactory
RW13	13	Runway 13-31	AAC	34,600	3.9	1/5/2021	10/14/2024	86	Good
TW	01B	Taxiway	AAC	38,938	39.3	8/15/1985	10/14/2024	29	Very Poor
TW	02A	Taxiway	AAC	53,876	3.9	1/5/2021	10/14/2024	91	Good
TW	02B	Taxiway	AC	9,582	3.9	1/1/2021	10/14/2024	94	Good
TW	02C	Taxiway	AC	10,849	3.9	1/1/2021	10/14/2024	94	Good
TW	03B	Taxiway	AC	26,181	26.3	8/1/1998	10/14/2024	67	Fair
TW	06	Taxiway	AC	14,342	26.3	8/1/1998	10/14/2024	75	Satisfactory
TW	07	Taxiway	AC	16,461	3.9	1/1/2021	10/14/2024	89	Good
TW	08	Taxiway	AC	36,423	3.9	1/1/2021	10/14/2024	94	Good
AP	02	Apron	AC	38,752	23.3	8/1/2001	10/14/2024	73	Satisfactory
AP	04	Apron	AC	96,647	23.3	8/1/2001	10/14/2024	72	Satisfactory
AP	05	Apron	PCC	2,065	35.3	7/31/1989	10/14/2024	0	Failed
AP	13	Apron	AC	64,179	9	11/6/2015	10/14/2024	90	Good
AP	13A	Apron	AC	61,445	23.3	8/1/2001	10/14/2024	71	Satisfactory

AIRFIELD PAVEMENT WORK HISTORY

1. AIP-001-1985, PFC ON RUNWAYS, TAXIWAYS, AND APRON
2. CONSTRUCT RUNWAY 4/22 SHOULDERS (RW04:21A) 3" AC IS STATE HIGHWAY GRADE B MIX, P-625 COAL TAR SEAL.
3. AIP-002-1989, REHABILITATE PORTION OF APRON.
4. AIP-005-1998, RECONSTRUCT AND NARROW RUNWAY 4-22 (RW04:21); RECONSTRUCT TAXIWAYS (TW:02A, TW:03B, TW:06, TW:07).
5. AIP-006-2001, REHABILITATE RUNWAY AND APRON.
6. AIP-007-2005, CRACK SEAL AND REMARK.
7. AIP-010/011-2008, MILL, OVERLAY, AND GROOVE RUNWAY 13-31 (RW13:11).
8. AIP-012-2011, CRACK SEAL, FOG SEAL, AND REMARK RUNWAYS (RW13:12, RW04:21), TAXIWAYS (TW:02, TW:03, TW:03B, TW:06, TW:07), AND APRONS (AP:01, AP:02, AP:13A, AP:04).
9. AIP-016-2015, RECONSTRUCT PORTION OF RUNWAY 4-22 (RW04:31) AND APRON (AP:13). CRACK SEAL, FOG SEAL AND REMARK ALL OTHER ELIGIBLE RUNWAY (RW04:21, RW13:12) PAVEMENTS.
10. AIP-020-2021, MILL AND OVERLAY RUNWAY 04-22 (RW04:21), RUNWAY 13-31 INTERSECTION (RW13:13), TAXIWAY B (TW:02A), AND TAXIWAY C (TW:16 & TW:18)
11. AIP-025-2023, CRACK SEAL, SURFACE SEAL, AND REMARK PAVEMENTS. (AP:02, AP:04, AP:13, RW04:31, TW:03B, TW:06).



This document, together with the concepts and designs presented herein, is an instrument of service, as an instrument of service, is intended only for the specific purpose and client for which it was prepared. Reuse of and improper reliance on this document without written authorization and adaptation by Kinney-Horn and Associates, Inc. shall be without liability to Kinney-Horn and Associates, Inc.

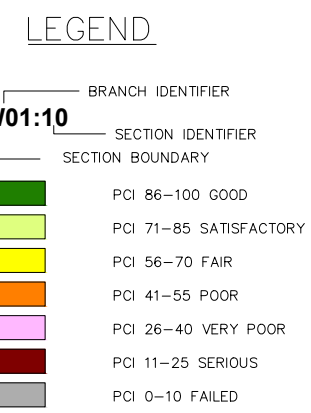
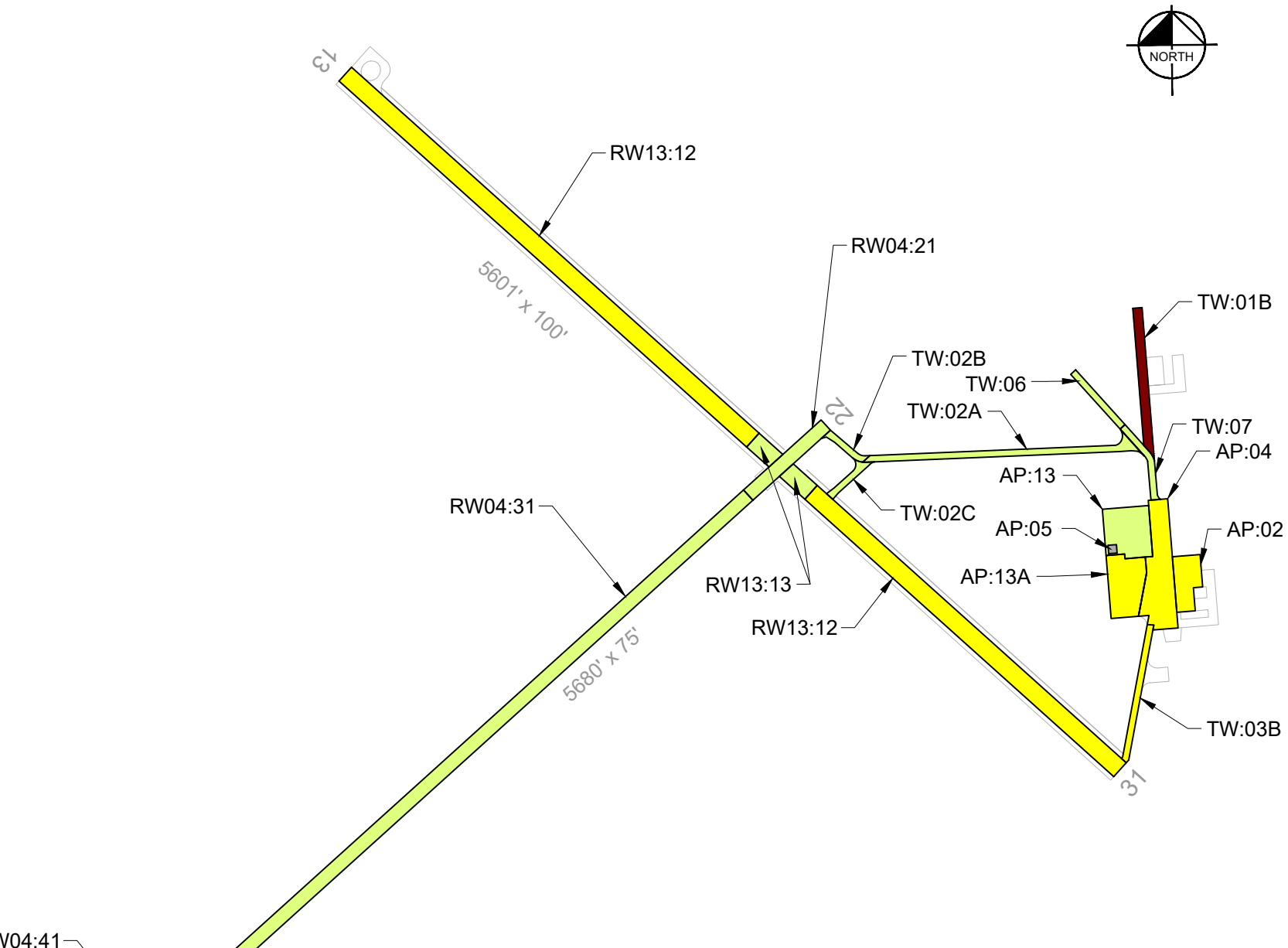

FORECASTED PAVEMENT CONDITION INDEX

Branch ID	Section ID	Surface Type	Current PCI (2024)	2025	2026	2027	2028	2029
RW04	21	AAC	94	93	91	88	86	84
RW04	31	AC	81	81	80	78	78	77
RW04	41	AC	94	93	91	88	86	84
RW13	12	AAC	73	73	72	72	71	70
RW13	13	AAC	86	86	84	82	81	79
TW	01B	AAC	29	28	24	19	15	11
TW	02A	AAC	91	90	88	86	84	82
TW	02B	AC	94	93	91	88	86	84
TW	02C	AC	94	93	91	88	86	84
TW	03B	AC	67	67	66	65	64	62
TW	06	AC	75	75	74	73	72	72
TW	07	AC	89	89	86	84	83	81
TW	08	AC	94	93	91	88	86	84
AP	02	AC	73	73	72	71	70	69
AP	04	AC	72	72	71	70	69	68
AP	05	PCC	0	0	0	0	0	0
AP	13	AC	90	89	87	85	83	81
AP	13A	AC	71	71	70	69	68	67



This document, together with the concepts and designs presented herein, is intended only for the specific purpose and client for which it was prepared. Reuse of and improper reliance on this document without written authorization and adaptation by Kinney-Horn and Associates, Inc. shall be without liability to Kinney-Horn and Associates, Inc.

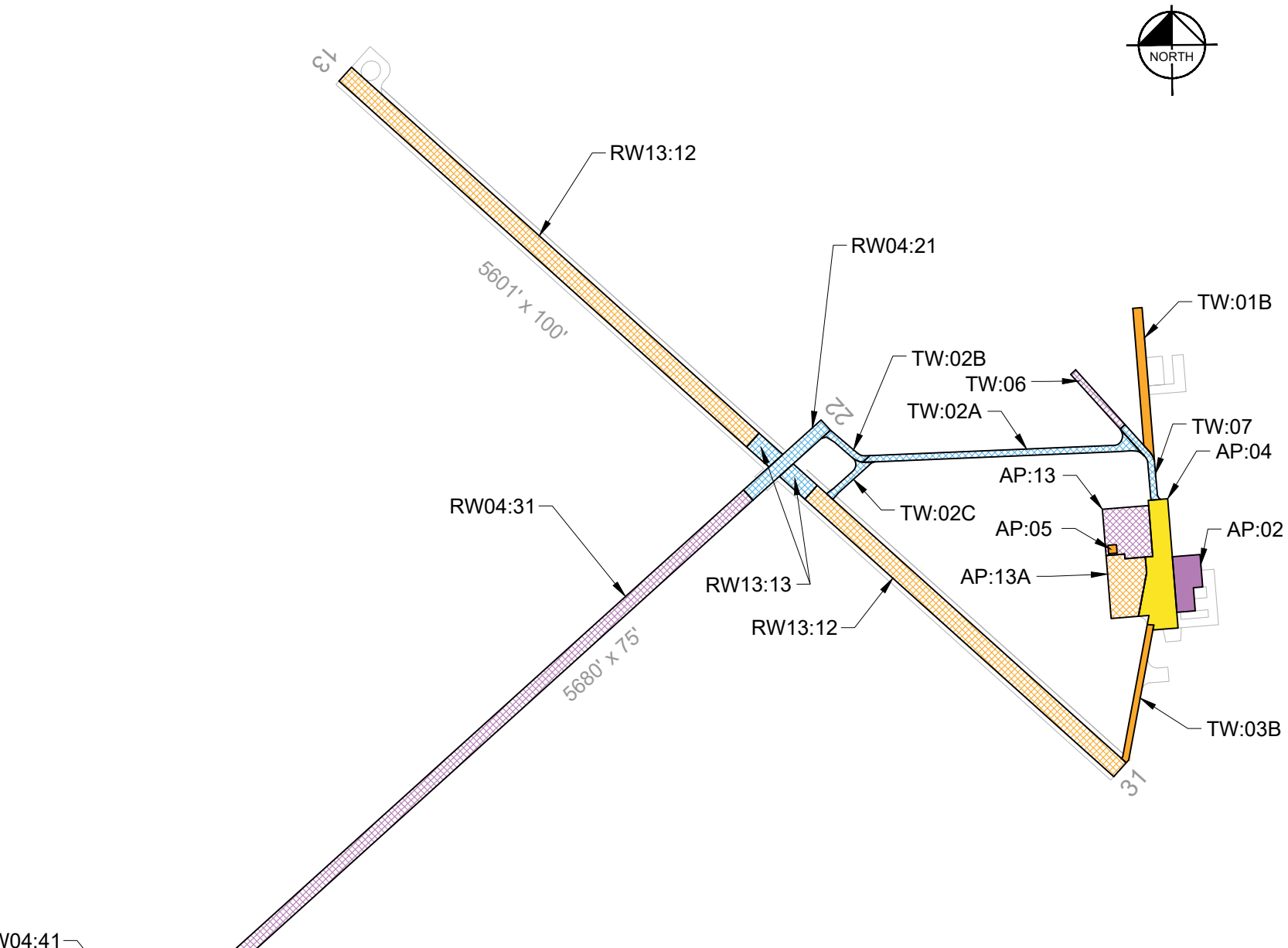

LEGEND

— BRANCH IDENTIFIER
 — SECTION IDENTIFIER
 — SECTION BOUNDARY

MAJOR REHABILITATION	GLOBAL TREATMENT
2025	2025
2026	2026
2027	2027
2028	2028
2029	2029

5-YEAR PAVEMENT NEEDS BY SECTION

Year	Branch ID	Section ID	Surface Type	Section Area (SF)	PCI at Treatment	Recommended Treatment	Treatment Category
2025	RW13	12	AAC	518,902	73	Crack Seal and Seal Coat	Global Treatment
2025	TW	01B	AAC	38,938	28	Full-Depth Reconstruction	Major Rehabilitation
2025	TW	03B	AC	26,181	67	Mill and Overlay	Major Rehabilitation
2025	AP	05	PCC	2,065	0	Full-Depth Reconstruction	Major Rehabilitation
2025	AP	13A	AC	61,445	71	Crack Seal and Seal Coat	Global Treatment
2026	RW04	21	AAC	42,225	91	Crack Seal and Seal Coat	Global Treatment
2026	RW04	41	AC	101,250	91	Crack Seal and Seal Coat	Global Treatment
2026	RW13	13	AAC	34,600	84	Crack Seal and Seal Coat	Global Treatment
2026	TW	02A	AAC	53,876	88	Crack Seal and Seal Coat	Global Treatment
2026	TW	02B	AC	9,582	91	Crack Seal and Seal Coat	Global Treatment
2026	TW	02C	AC	10,849	91	Crack Seal and Seal Coat	Global Treatment
2026	TW	07	AC	16,461	86	Crack Seal and Seal Coat	Global Treatment
2026	TW	08	AC	36,423	91	Crack Seal and Seal Coat	Global Treatment
2027	AP	04	AC	96,647	70	Mill and Overlay	Major Rehabilitation
2028	RW04	31	AC	288,750	78	Crack Seal and Seal Coat	Global Treatment
2028	TW	06	AC	14,342	72	Crack Seal and Seal Coat	Global Treatment
2028	AP	02	AC	38,752	70	Mill and Overlay	Major Rehabilitation
2028	AP	13	AC	64,179	83	Crack Seal and Seal Coat	Global Treatment



Runway



RW04-31-15: Weathering



RW13-12-76: L&T Cracking

Taxiway



TW-01B-07: Overview



TW-01B-10: Alligator Cracking

Apron



AP-02-04: Weathering



AP-04-04: Alligator Cracking



AP-05-01: Shattered Slab/Intersecting Cracks



AP-13-10: Overview and Bleeding

Re-Inspection Report

MDT SASP 2024

Generated Date 1/7/2025

Page 1 of 18

Network: MLS **Name:** Frank Wiley Field

Branch: AP **Name:** Apron **Use:** APRON **Area:** 263,088 SqFt

Section: 02 of 5 **From:** SOUTHEAST APRON **To:** **Last Const.:** 8/1/2001

Surface: AC **Family:** _MDT2024 - AP AC **Zone:** MILE **Category:** D **Rank:** P

Area: 38,752 SqFt **Length:** 775 Ft **Width:** 50 Ft

Slabs: **Slab Length:** Ft **Slab Width:** Ft **Joint Length:** Ft

Shoulder: **Street Type:** ACN **Grade:** 0 **Lanes:** 0

Section Comments:

Work Date: 8/15/1985 **Work Type:** New Construction - Initial **Code:** NU-IN **Is Major M&R:** True

Work Date: 8/1/2001 **Work Type:** Complete Reconstruction - AC **Code:** CR-AC **Is Major M&R:** True

Work Date: 1/1/2023 **Work Type:** Crack Sealing - AC **Code:** CS-AC **Is Major M&R:** False

Work Date: 1/1/2023 **Work Type:** Surface Seal - Seal Coat **Code:** SS-SC **Is Major M&R:** False

Last Insp. Date: 10/14/2024 **TotalSamples:** 8 **Surveyed:** 4

Conditions: PCI: 73

Inspection Comments:

Sample Number: 02 **Type:** R **Area:** 5000.00 SqFt **PCI:** 78

Sample Comments:

48 L & T CR L 352.00 Ft
57 WEATHERING L 1250.00 SqFt

Sample Number: 04 **Type:** R **Area:** 5000.00 SqFt **PCI:** 72

Sample Comments:

42 BLEEDING N 21.00 SqFt
48 L & T CR L 390.00 Ft
50 PATCHING L 12.00 SqFt
57 WEATHERING L 1247.00 SqFt

Sample Number: 06 **Type:** R **Area:** 5000.00 SqFt **PCI:** 74

Sample Comments:

48 L & T CR L 478.00 Ft
57 WEATHERING L 1250.00 SqFt

Sample Number: 08 **Type:** R **Area:** 4375.00 SqFt **PCI:** 65

Sample Comments:

48 L & T CR L 684.00 Ft
50 PATCHING L 12.00 SqFt
57 WEATHERING L 1091.00 SqFt

Network:	MLS		Name:	Frank Wiley Field			
Branch:	AP	Name:	Apron	Use:	APRON	Area:	263,088 SqFt
Section:	04	of 5	From:	FBO APRON AREA	To:		Last Const.: 8/1/2001
Surface:	AC	Family:	_MDT2024 - AP AC	Zone:	MILE	Category:	D
Area:	96,647 SqFt	Length:	700 Ft	Width:	150 Ft		
Slabs:		Slab Length:	Ft	Slab Width:	Ft	Joint Length:	Ft
Shoulder:		Street Type:	ACN	Grade:	0	Lanes:	0
Section Comments:							
Work Date:	8/15/1985	Work Type:	New Construction - Initial	Code:	NU-IN	Is Major M&R:	True
Work Date:	8/1/2001	Work Type:	Complete Reconstruction - AC	Code:	CR-AC	Is Major M&R:	True
Work Date:	1/1/2023	Work Type:	Surface Seal - Seal Coat	Code:	SS-SC	Is Major M&R:	False
Work Date:	1/1/2023	Work Type:	Crack Sealing - AC	Code:	CS-AC	Is Major M&R:	False
Last Insp. Date:	10/14/2024	TotalSamples:	19	Surveyed:	6		
Conditions:	PCI: 72						
Inspection Comments:							
Sample Number:	01	Type:	R	Area:	5500.00 SqFt	PCI:	75
Sample Comments:							
48	L & T CR	L	483.00	Ft			
57	WEATHERING	L	1375.00	SqFt			
Sample Number:	04	Type:	R	Area:	5500.00 SqFt	PCI:	68
Sample Comments:							
41	ALLIGATOR CR	L	21.00	SqFt			
48	L & T CR	L	579.00	Ft			
57	WEATHERING	L	1375.00	SqFt			
Sample Number:	06	Type:	R	Area:	5500.00 SqFt	PCI:	72
Sample Comments:							
48	L & T CR	L	616.00	Ft			
57	WEATHERING	L	1375.00	SqFt			
Sample Number:	08	Type:	R	Area:	4950.00 SqFt	PCI:	73
Sample Comments:							
48	L & T CR	L	499.00	Ft			
57	WEATHERING	L	1238.00	SqFt			
Sample Number:	13	Type:	R	Area:	5000.00 SqFt	PCI:	73
Sample Comments:							
48	L & T CR	L	497.00	Ft			
57	WEATHERING	L	1610.00	SqFt			
Sample Number:	16	Type:	R	Area:	4100.00 SqFt	PCI:	73
Sample Comments:							
48	L & T CR	L	410.00	Ft			
57	WEATHERING	L	1025.00	SqFt			

Network: MLS **Name:** Frank Wiley Field

Branch: AP **Name:** Apron **Use:** APRON **Area:** 263,088 SqFt

Section: 05 of 5 **From:** 50' x 50' PCC **To:** **Last Const.:** 7/31/1989

Surface: PCC **Family:** _MDT2024 - All PCC **Zone:** MILE **Category:** P **Rank:** P

Area: 2,065 SqFt **Length:** 50 Ft **Width:** 50 Ft

Slabs: 4 **Slab Length:** 25 Ft **Slab Width:** 25 Ft **Joint Length:** 100 Ft

Shoulder: **Street Type:** ACN **Grade:** 0 **Lanes:** 0

Section Comments:

Work Date: 7/31/1989 **Work Type:** New Construction - Initial **Code:** NU-IN **Is Major M&R:** True

Last Insp. Date: 10/14/2024 **TotalSamples:** 1 **Surveyed:** 1

Conditions: PCI: 0

Inspection Comments:

Sample Number: 01 **Type:** R **Area:** 4.00 Slabs **PCI:** 0

Sample Comments:

65	JT SEAL DMG	H	4.00	Slabs
72	SHAT. SLAB	M	3.00	Slabs
72	SHAT. SLAB	H	1.00	Slabs

Network:	MLS	Name:	Frank Wiley Field					
Branch:	AP	Name:	Apron	Use:	APRON	Area:	263,088 SqFt	
Section:	13	of 5	From:	NORTHWEST APRON	To:	1	Last Const.:	11/6/2015
Surface:	AC	Family:	_MDT2024 - AP AC	Zone:		Category:	Rank:	P
Area:	64,179 SqFt	Length:	250 Ft	Width:	250 Ft			
Slabs:		Slab Length:	Ft	Slab Width:	Ft	Joint Length:	Ft	
Shoulder:		Street Type:		Grade:	0	Lanes:	0	
Section Comments:								
Work Date:	11/6/2015	Work Type:	New Construction - AC	Code:	NC-AC	Is Major M&R:	True	
Work Date:	1/1/2023	Work Type:	Crack Sealing - AC	Code:	CS-AC	Is Major M&R:	False	
Work Date:	1/1/2023	Work Type:	Surface Seal - Seal Coat	Code:	SS-SC	Is Major M&R:	False	
Last Insp. Date:	10/14/2024	TotalSamples:	11	Surveyed:	4			
Conditions:	PCI: 90							
Inspection Comments:								
Sample Number:	01	Type:	R	Area:	4736.00 SqFt	PCI:	89	
Sample Comments:								
48	L & T CR	L	93.00	Ft				
57	WEATHERING	L	1184.00	SqFt				
Sample Number:	04	Type:	R	Area:	4736.00 SqFt	PCI:	90	
Sample Comments:								
48	L & T CR	L	80.00	Ft				
57	WEATHERING	L	1184.00	SqFt				
Sample Number:	07	Type:	R	Area:	4736.00 SqFt	PCI:	86	
Sample Comments:								
48	L & T CR	L	128.00	Ft				
57	WEATHERING	L	2368.00	SqFt				
Sample Number:	10	Type:	R	Area:	4736.00 SqFt	PCI:	93	
Sample Comments:								
48	L & T CR	L	18.00	Ft				
57	WEATHERING	L	1184.00	SqFt				

Network: MLS **Name:** Frank Wiley Field

Branch: AP **Name:** Apron **Use:** APRON **Area:** 263,088 SqFt

Section: 13A of 5 **From:** SOUTHWEST APRON **To:** **Last Const.:** 8/1/2001

Surface: AC **Family:** _MDT2024 - AP AC **Zone:** MILE **Category:** D **Rank:** P

Area: 61,445 SqFt **Length:** 1,279 Ft **Width:** 50 Ft

Slabs: **Slab Length:** Ft **Slab Width:** Ft **Joint Length:** Ft

Shoulder: **Street Type:** ACN **Grade:** 0 **Lanes:** 0

Section Comments:

Work Date: 7/31/1989 **Work Type:** New Construction - Initial **Code:** NU-IN **Is Major M&R:** True

Work Date: 8/1/2001 **Work Type:** Complete Reconstruction - AC **Code:** CR-AC **Is Major M&R:** True

Last Insp. Date: 10/14/2024 **Total Samples:** 12 **Surveyed:** 4

Conditions: PCI: 71

Inspection Comments:

Sample Number: 03 **Type:** R **Area:** 5000.00 SqFt **PCI:** 67

Sample Comments:

48 L & T CR L 301.00 Ft
48 L & T CR M 125.00 Ft
57 WEATHERING L 3750.00 SqFt
57 WEATHERING M 1250.00 SqFt

Sample Number: 06 **Type:** R **Area:** 5000.00 SqFt **PCI:** 69

Sample Comments:

48 L & T CR L 271.00 Ft
48 L & T CR M 38.00 Ft
57 WEATHERING L 3750.00 SqFt
57 WEATHERING M 1250.00 SqFt

Sample Number: 09 **Type:** R **Area:** 4271.00 SqFt **PCI:** 70

Sample Comments:

42 BLEEDING N 3.00 SqFt
48 L & T CR L 212.00 Ft
48 L & T CR M 50.00 Ft
57 WEATHERING L 3203.00 SqFt
57 WEATHERING M 1068.00 SqFt

Sample Number: 12 **Type:** R **Area:** 5500.00 SqFt **PCI:** 77

Sample Comments:

48 L & T CR L 432.00 Ft
57 WEATHERING L 1375.00 SqFt

Network:	MLS		Name:	Frank Wiley Field			
Branch:	RW04	Name:	Runway 04-22	Use:	RUNWAY	Area:	432,225 SqFt
Section:	21	of 3	From:	T-6	To:	T-5B	Last Const.: 1/5/2021
Surface:	AAC	Family:	_MDT2024 - RW AC AAC	Zone:	MILE	Category:	D
Area:	42,225 SqFt	Length:	1,680 Ft	Width:	75 Ft	Rank:	P
Slabs:	Slab Length:	Ft	Slab Width:	Ft	Joint Length:	Ft	
Shoulder:	Street Type:	ACM	Grade:	0	Lanes:	0	
Section Comments:							
Work Date:	8/1/1998	Work Type:	New Construction - Initial	Code:	NU-IN	Is Major M&R:	True
Work Date:	1/5/2021	Work Type:	Mill and AC Overlay	Code:	ML-AOL	Is Major M&R:	True
Last Insp. Date:	10/14/2024	TotalSamples:	11	Surveyed:	4		
Conditions:	PCI:	94					
Inspection Comments:							
Sample Number:	01	Type:	R	Area:	3750.00 SqFt	PCI:	94
Sample Comments:							
57	WEATHERING	L		3750.00	SqFt		
Sample Number:	04	Type:	R	Area:	3750.00 SqFt	PCI:	94
Sample Comments:							
57	WEATHERING	L		3750.00	SqFt		
Sample Number:	07	Type:	R	Area:	3750.00 SqFt	PCI:	94
Sample Comments:							
57	WEATHERING	L		3750.00	SqFt		
Sample Number:	10	Type:	R	Area:	3750.00 SqFt	PCI:	94
Sample Comments:							
57	WEATHERING	L		3750.00	SqFt		

Network:	MLS	Name:	Frank Wiley Field					
Branch:	RW04	Name:	Runway 04-22	Use:	RUNWAY	Area:	432,225 SqFt	
Section:	31	of 3	From:	STA. 0+00	To:	STA. 40+00	Last Const.:	11/6/2015
Surface:	AC	Family:	_MDT2024 - RW AC AAC		Zone:	Category:	Rank:	P
Area:	288,750 SqFt	Length:	4,000 Ft	Width:	75 Ft			
Slabs:	Slab Length:	Ft	Slab Width:	Ft	Joint Length:	Ft		
Shoulder:	Street Type:	Grade:	0	Lanes:	0			
Section Comments:								
Work Date:	11/6/2015	Work Type:	New Construction - AC		Code:	NC-AC	Is Major M&R:	True
Work Date:	1/1/2023	Work Type:	Surface Seal - Seal Coat		Code:	SS-SC	Is Major M&R:	False
Work Date:	1/1/2023	Work Type:	Crack Sealing - AC		Code:	CS-AC	Is Major M&R:	False
Last Insp. Date:	10/14/2024	TotalSamples:	80	Surveyed:	8			
Conditions:	PCI:	81						
Inspection Comments:								
Sample Number:	03	Type:	R	Area:	3750.00 SqFt	PCI:	80	
Sample Comments:								
48	L & T CR	L	250.00	Ft				
57	WEATHERING	L	375.00	SqFt				
Sample Number:	15	Type:	R	Area:	3750.00 SqFt	PCI:	82	
Sample Comments:								
48	L & T CR	L	217.00	Ft				
57	WEATHERING	L	375.00	SqFt				
Sample Number:	27	Type:	R	Area:	3750.00 SqFt	PCI:	83	
Sample Comments:								
48	L & T CR	L	192.00	Ft				
57	WEATHERING	L	375.00	SqFt				
Sample Number:	39	Type:	R	Area:	3750.00 SqFt	PCI:	82	
Sample Comments:								
48	L & T CR	L	218.00	Ft				
57	WEATHERING	L	375.00	SqFt				
Sample Number:	45	Type:	R	Area:	3750.00 SqFt	PCI:	82	
Sample Comments:								
48	L & T CR	L	200.00	Ft				
57	WEATHERING	L	750.00	SqFt				
Sample Number:	51	Type:	R	Area:	3750.00 SqFt	PCI:	78	
Sample Comments:								
48	L & T CR	L	288.00	Ft				
57	WEATHERING	L	375.00	SqFt				
Sample Number:	63	Type:	R	Area:	3750.00 SqFt	PCI:	81	
Sample Comments:								
48	L & T CR	L	227.00	Ft				
57	WEATHERING	L	375.00	SqFt				
Sample Number:	75	Type:	R	Area:	3750.00 SqFt	PCI:	80	
Sample Comments:								
48	L & T CR	L	256.00	Ft				
57	WEATHERING	L	375.00	SqFt				

Network:	MLS	Name:	Frank Wiley Field					
Branch:	RW04	Name:	Runway 04-22	Use:	RUNWAY	Area:	432,225 SqFt	
Section:	41	of 3	From:	RW4:31	To:	RW	Last Const.:	1/1/2021
Surface:	AC	Family:	_MDT2024 - RW AC AAC		Zone:	Category:	Rank:	P
Area:	101,250 SqFt	Length:	1,335 Ft	Width:	75 Ft			
Slabs:	Slab Length:	Ft	Slab Width:	Ft	Joint Length:	Ft		
Shoulder:	Street Type:	Grade:	0	Lanes:	0			
Section Comments:								
Work Date:	1/1/2021	Work Type:	New Construction - AC		Code:	NC-AC	Is Major M&R:	True
Last Insp. Date:	10/14/2024	TotalSamples:	27	Surveyed:	5			
Conditions:	PCI: 94							
Inspection Comments:								
Sample Number:	03	Type:	R	Area:	3750.00 SqFt	PCI:	94	
Sample Comments:								
57	WEATHERING	L		3750.00 SqFt				
Sample Number:	09	Type:	R	Area:	3750.00 SqFt	PCI:	94	
Sample Comments:								
57	WEATHERING	L		3750.00 SqFt				
Sample Number:	15	Type:	R	Area:	3750.00 SqFt	PCI:	94	
Sample Comments:								
57	WEATHERING	L		3750.00 SqFt				
Sample Number:	21	Type:	R	Area:	3750.00 SqFt	PCI:	94	
Sample Comments:								
57	WEATHERING	L		3750.00 SqFt				
Sample Number:	27	Type:	R	Area:	3750.00 SqFt	PCI:	94	
Sample Comments:								
57	WEATHERING	L		3750.00 SqFt				

Network:	MLS		Name:	Frank Wiley Field							
Branch:	RW13	Name:	Runway 13-31	Use:	RUNWAY	Area:	553,502 SqFt				
Section:	12	of	2	From:	RUNWAY 12-30 FROM T-3B		To:	T-5	Last Const.:	8/1/2008	
Surface:	AAC	Family:	_MDT2024 - RW AC AAC	Zone:	MILE	Category:	H	Rank:	P		
Area:	518,902 SqFt	Length:	5,601 Ft	Width:	100 Ft						
Slabs:		Slab Length:	Ft	Slab Width:	Ft		Joint Length:	Ft			
Shoulder:		Street Type:	ACH	Grade:	0		Lanes:	0			
Section Comments:											
Work Date:	8/1/2008		Work Type:	New Construction - Initial			Code:	NU-IN		Is Major M&R:	True
Last Insp. Date:	10/14/2024		TotalSamples:	110			Surveyed:	7			
Conditions:	PCI: 73										
Inspection Comments:											
Sample Number:	104	Type:	R	Area:	5000.00 SqFt		PCI:	73			
Sample Comments:											
48	L & T CR	L	171.00	Ft							
48	L & T CR	M	120.00	Ft							
57	WEATHERING	M	750.00	SqFt							
Sample Number:	12	Type:	R	Area:	5000.00 SqFt		PCI:	83			
Sample Comments:											
48	L & T CR	L	71.00	Ft							
57	WEATHERING	L	4250.00	SqFt							
57	WEATHERING	M	750.00	SqFt							
Sample Number:	28	Type:	R	Area:	5000.00 SqFt		PCI:	80			
Sample Comments:											
48	L & T CR	L	147.00	Ft							
57	WEATHERING	L	4250.00	SqFt							
57	WEATHERING	M	750.00	SqFt							
Sample Number:	44	Type:	R	Area:	5000.00 SqFt		PCI:	71			
Sample Comments:											
48	L & T CR	L	360.00	Ft							
57	WEATHERING	L	4250.00	SqFt							
57	WEATHERING	M	750.00	SqFt							
Sample Number:	60	Type:	R	Area:	5000.00 SqFt		PCI:	61			
Sample Comments:											
45	DEPRESSION	L	134.00	SqFt							
48	L & T CR	L	370.00	Ft							
48	L & T CR	M	16.00	Ft							
57	WEATHERING	L	4250.00	SqFt							
57	WEATHERING	M	750.00	SqFt							
Sample Number:	76	Type:	R	Area:	5000.00 SqFt		PCI:	69			
Sample Comments:											
48	L & T CR	L	273.00	Ft							
48	L & T CR	M	25.00	Ft							
57	WEATHERING	L	4250.00	SqFt							
57	WEATHERING	M	750.00	SqFt							
Sample Number:	92	Type:	R	Area:	5000.00 SqFt		PCI:	71			
Sample Comments:											
48	L & T CR	L	224.00	Ft							
48	L & T CR	M	25.00	Ft							
57	WEATHERING	L	4250.00	SqFt							
57	WEATHERING	M	750.00	SqFt							

Network:	MLS	Name:	Frank Wiley Field						
Branch:	RW13	Name:	Runway 13-31	Use:	RUNWAY	Area:	553,502 SqFt		
Section:	13	of	2	From:	RW13	To:	RW13	Last Const.:	1/5/2021
Surface:	AAC	Family:	_MDT2024 - RW AC AAC		Zone:	Category:	Rank: P		
Area:	34,600 SqFt	Length:	346 Ft	Width:	100 Ft				
Slabs:	Slab Length:	Ft	Slab Width:	Ft	Joint Length:	Ft			
Shoulder:	Street Type:	Grade:	0	Lanes:	0				
Section Comments:									
Work Date:	8/1/1998	Work Type:	New Construction - Initial		Code:	NU-IN	Is Major M&R:	True	
Work Date:	1/5/2021	Work Type:	Mill and AC Overlay		Code:	ML-AOL	Is Major M&R:	True	
Last Insp. Date:	10/14/2024	TotalSamples:	7	Surveyed:	4				
Conditions:	PCI:	86							
Inspection Comments:									
Sample Number:	01	Type:	R	Area:	5000.00 SqFt	PCI:	86		
Sample Comments:									
48	L & T CR	L	139.00	Ft					
57	WEATHERING	L	5000.00	SqFt					
Sample Number:	03	Type:	R	Area:	5000.00 SqFt	PCI:	89		
Sample Comments:									
48	L & T CR	L	80.00	Ft					
57	WEATHERING	L	5000.00	SqFt					
Sample Number:	06	Type:	R	Area:	5000.00 SqFt	PCI:	85		
Sample Comments:									
48	L & T CR	L	140.00	Ft					
57	WEATHERING	L	5000.00	SqFt					
Sample Number:	07	Type:	R	Area:	5000.00 SqFt	PCI:	83		
Sample Comments:									
48	L & T CR	L	186.00	Ft					
57	WEATHERING	L	5000.00	SqFt					

Network: MLS **Name:** Frank Wiley Field

Branch: TW **Name:** Taxiway **Use:** TAXIWAY **Area:** 206,652 SqFt

Section: 01B of 8 **From:** INTERSECTION WITH T-2 **To:** 22 END OF RUNWAY 4-22 **Last Const.:** 8/15/1985

Surface: AAC **Family:** _MDT2024 - TW AAC **Zone:** MILE **Category:** E **Rank:** P

Area: 38,938 SqFt **Length:** 760 Ft **Width:** 50 Ft

Slabs: **Slab Length:** Ft **Slab Width:** Ft **Joint Length:** Ft

Shoulder: **Street Type:** ACM **Grade:** 0 **Lanes:** 0

Section Comments: T-1 MILLED FROM 1300' IN 1998

Work Date: 8/15/1985 **Work Type:** New Construction - Initial **Code:** NU-IN **Is Major M&R:** True

Last Insp. Date: 10/14/2024 **TotalSamples:** 7 **Surveyed:** 4

Conditions: PCI: 29

Inspection Comments:

Sample Number: 02 **Type:** R **Area:** 5000.00 SqFt **PCI:** 24

Sample Comments:

41	ALLIGATOR CR	L	150.00	SqFt
41	ALLIGATOR CR	M	85.00	SqFt
48	L & T CR	L	150.00	Ft
48	L & T CR	M	250.00	Ft
50	PATCHING	M	1482.00	SqFt
57	WEATHERING	M	3518.00	SqFt

Sample Number: 04 **Type:** R **Area:** 5000.00 SqFt **PCI:** 27

Sample Comments:

41	ALLIGATOR CR	L	200.00	SqFt
41	ALLIGATOR CR	M	200.00	SqFt
48	L & T CR	L	200.00	Ft
48	L & T CR	M	158.00	Ft
53	RUTTING	L	100.00	SqFt
57	WEATHERING	M	5000.00	SqFt

Sample Number: 06 **Type:** R **Area:** 5000.00 SqFt **PCI:** 42

Sample Comments:

41	ALLIGATOR CR	M	88.00	SqFt
48	L & T CR	L	150.00	Ft
48	L & T CR	M	250.00	Ft
48	L & T CR	H	40.00	Ft
57	WEATHERING	M	5000.00	SqFt

Sample Number: 07 **Type:** R **Area:** 5000.00 SqFt **PCI:** 25

Sample Comments:

41	ALLIGATOR CR	L	150.00	SqFt
41	ALLIGATOR CR	M	75.00	SqFt
48	L & T CR	L	209.00	Ft
48	L & T CR	M	200.00	Ft
50	PATCHING	M	1482.00	SqFt
57	WEATHERING	M	3518.00	SqFt

Network:	MLS		Name:	Frank Wiley Field					
Branch:	TW	Name:	Taxiway	Use:	TAXIWAY	Area:	206,652 SqFt		
Section:	02A	of 8	From:	RUNWAY INTERSECTION	To:	T-1B	Last Const.:	1/5/2021	
Surface:	AAC	Family:	_MDT2024 - TW AAC	Zone:	MILE	Category:	E	Rank:	P
Area:	53,876 SqFt	Length:	1,800 Ft	Width:	35 Ft				
Slabs:		Slab Length:	Ft	Slab Width:	Ft	Joint Length:	Ft		
Shoulder:		Street Type:	ACM	Grade:	0	Lanes:	0		
Section Comments:									
Work Date:	8/1/1998	Work Type:	New Construction - Initial	Code:	NU-IN	Is Major M&R:	True		
Work Date:	1/5/2021	Work Type:	Mill and AC Overlay	Code:	ML-AOL	Is Major M&R:	True		
Last Insp. Date:	10/14/2024	TotalSamples:	10	Surveyed:	4				
Conditions:	PCI: 91								
Inspection Comments:									
Sample Number:	01	Type:	R	Area:	5463.00 SqFt	PCI:	94		
Sample Comments:									
57	WEATHERING	L		5463.00	SqFt				
Sample Number:	04	Type:	R	Area:	5250.00 SqFt	PCI:	90		
Sample Comments:									
48	L & T CR	L		15.00	Ft				
57	WEATHERING	L		5250.00	SqFt				
Sample Number:	07	Type:	R	Area:	5250.00 SqFt	PCI:	90		
Sample Comments:									
48	L & T CR	L		35.00	Ft				
57	WEATHERING	L		5250.00	SqFt				
Sample Number:	10	Type:	R	Area:	6809.00 SqFt	PCI:	90		
Sample Comments:									
48	L & T CR	L		35.00	Ft				
57	WEATHERING	L		6809.00	SqFt				

Network:	MLS	Name:	Frank Wiley Field						
Branch:	TW	Name:	Taxiway	Use:	TAXIWAY	Area:	206,652 SqFt		
Section:	02B	of 8	From:	TW02A	To:	RW4:21	Last Const.:	1/1/2021	
Surface:	AC	Family:	_MDT2024 - TW AC	Zone:		Category:		Rank:	P
Area:	9,582 SqFt	Length:	244 Ft	Width:	35 Ft				
Slabs:		Slab Length:	Ft	Slab Width:	Ft	Joint Length:	Ft		
Shoulder:		Street Type:		Grade:	0	Lanes:	0		
Section Comments:									
Work Date:	1/1/2021	Work Type:	New Construction - AC		Code:	NC-AC	Is Major M&R:	True	
Last Insp. Date:	10/14/2024	TotalSamples:	2		Surveyed:	2			
Conditions:	PCI: 94								
Inspection Comments:									
Sample Number:	01	Type:	R	Area:	4708.00 SqFt	PCI:	94		
Sample Comments:									
57	WEATHERING	L		4708.00	SqFt				
Sample Number:	02	Type:	R	Area:	4874.00 SqFt	PCI:	94		
Sample Comments:									
57	WEATHERING	L		4874.00	SqFt				

Network:	MLS	Name:	Frank Wiley Field					
Branch:	TW	Name:	Taxiway	Use:	TAXIWAY	Area:	206,652 SqFt	
Section:	02C	of 8	From:	TW02A	To:	RW13:12	Last Const.:	1/1/2021
Surface:	AC	Family:	_MDT2024 - TW AC	Zone:		Category:	Rank:	P
Area:	10,849 SqFt	Length:	302 Ft	Width:	35 Ft			
Slabs:		Slab Length:	Ft	Slab Width:	Ft	Joint Length:	Ft	
Shoulder:		Street Type:		Grade:	0	Lanes:	0	
Section Comments:								
Work Date:	1/1/2021	Work Type:	New Construction - AC		Code:	NC-AC	Is Major M&R:	True
Last Insp. Date:	10/14/2024	Total Samples:	2	Surveyed:	2			
Conditions:	PCI: 94							
Inspection Comments:								
Sample Number:	01	Type:	R	Area:	5024.00 SqFt	PCI:	94	
Sample Comments:								
57	WEATHERING	L		5024.00 SqFt				
Sample Number:	02	Type:	R	Area:	5825.00 SqFt	PCI:	94	
Sample Comments:								
57	WEATHERING	L		5825.00 SqFt				

Network: MLS **Name:** Frank Wiley Field

Branch: TW **Name:** Taxiway **Use:** TAXIWAY **Area:** 206,652 SqFt

Section: 03B of 8 **From:** 30 END OF RW 12-30 **To:** APRON **Last Const.:** 8/1/1998

Surface: AC **Family:** _MDT2024 - TW AC **Zone:** **Category:** G **Rank:** P

Area: 26,181 SqFt **Length:** 800 Ft **Width:** 35 Ft

Slabs: **Slab Length:** Ft **Slab Width:** Ft **Joint Length:** Ft

Shoulder: **Street Type:** ACH **Grade:** 0 **Lanes:** 0

Section Comments:

Work Date: 8/1/1998 **Work Type:** New Construction - Initial **Code:** NU-IN **Is Major M&R:** True

Work Date: 1/1/2023 **Work Type:** Surface Seal - Seal Coat **Code:** SS-SC **Is Major M&R:** False

Work Date: 1/1/2023 **Work Type:** Crack Sealing - AC **Code:** CS-AC **Is Major M&R:** False

Last Insp. Date: 10/14/2024 **TotalSamples:** 7 **Surveyed:** 4

Conditions: PCI: 67

Inspection Comments:

Sample Number: 01 **Type:** R **Area:** 3500.00 SqFt **PCI:** 59

Sample Comments:

41 ALLIGATOR CR L 75.00 SqFt

48 L & T CR L 298.00 Ft

52 RAVELING L 50.00 SqFt

57 WEATHERING L 3450.00 SqFt

Sample Number: 03 **Type:** R **Area:** 3500.00 SqFt **PCI:** 66

Sample Comments:

48 L & T CR L 428.00 Ft

52 RAVELING L 50.00 SqFt

57 WEATHERING L 3450.00 SqFt

Sample Number: 04 **Type:** R **Area:** 3500.00 SqFt **PCI:** 74

Sample Comments:

48 L & T CR L 210.00 Ft

52 RAVELING L 80.00 SqFt

57 WEATHERING L 3420.00 SqFt

Sample Number: 06 **Type:** R **Area:** 3500.00 SqFt **PCI:** 69

Sample Comments:

48 L & T CR L 308.00 Ft

52 RAVELING L 80.00 SqFt

57 WEATHERING L 3420.00 SqFt

Network: MLS **Name:** Frank Wiley Field

Branch: TW **Name:** Taxiway **Use:** TAXIWAY **Area:** 206,652 SqFt

Section: 06 of 8 **From:** 22 END OF RW 4-22 **To:** A-4 **Last Const.:** 8/1/1998

Surface: AC **Family:** _MDT2024 - TW AC **Zone:** MILE **Category:** D **Rank:** P

Area: 14,342 SqFt **Length:** 1,440 Ft **Width:** 35 Ft

Slabs: **Slab Length:** Ft **Slab Width:** Ft **Joint Length:** Ft

Shoulder: **Street Type:** ACM **Grade:** 0 **Lanes:** 0

Section Comments:

Work Date: 8/1/1998 **Work Type:** New Construction - Initial **Code:** NU-IN **Is Major M&R:** True

Work Date: 1/1/2023 **Work Type:** Surface Seal - Seal Coat **Code:** SS-SC **Is Major M&R:** False

Work Date: 1/1/2023 **Work Type:** Crack Sealing - AC **Code:** CS-AC **Is Major M&R:** False

Last Insp. Date: 10/14/2024 **TotalSamples:** 10 **Surveyed:** 2

Conditions: PCI: 75

Inspection Comments:

Sample Number: 05 **Type:** R **Area:** 5040.00 SqFt **PCI:** 76

Sample Comments:

48 L & T CR L 428.00 Ft

57 WEATHERING L 1260.00 SqFt

Sample Number: 07 **Type:** R **Area:** 5000.00 SqFt **PCI:** 75

Sample Comments:

48 L & T CR L 443.00 Ft

57 WEATHERING L 1250.00 SqFt

Network: MLS **Name:** Frank Wiley Field

Branch: TW **Name:** Taxiway **Use:** TAXIWAY **Area:** 206,652 SqFt

Section: 07 of 8 **From:** AP04 **To:** TW06 **Last Const.:** 1/1/2021

Surface: AC **Family:** _MDT2024 - TW AC **Zone:** **Category:** **Rank:** P

Area: 16,461 SqFt **Length:** 438 Ft **Width:** 35 Ft

Slabs: **Slab Length:** Ft **Slab Width:** Ft **Joint Length:** Ft

Shoulder: **Street Type:** **Grade:** 0 **Lanes:** 0

Section Comments:

Work Date: 1/1/2021 **Work Type:** New Construction - AC **Code:** NC-AC **Is Major M&R:** True

Last Insp. Date: 10/14/2024 **TotalSamples:** 3 **Surveyed:** 2

Conditions: PCI: 89

Inspection Comments:

Sample Number: 01 **Type:** R **Area:** 5615.00 SqFt **PCI:** 90

Sample Comments:

48 L & T CR L 35.00 Ft

57 WEATHERING L 5615.00 SqFt

Sample Number: 03 **Type:** R **Area:** 5397.00 SqFt **PCI:** 89

Sample Comments:

48 L & T CR L 85.00 Ft

57 WEATHERING L 5397.00 SqFt

Network:	MLS	Name:	Frank Wiley Field					
Branch:	TW	Name:	Taxiway	Use:	TAXIWAY	Area:	206,652 SqFt	
Section:	08	of 8	From:	RW4:41	To:	RW4:41	Last Const.:	1/1/2021
Surface:	AC	Family:	_MDT2024 - TW AC	Zone:		Category:	Rank:	P
Area:	36,423 SqFt	Length:	280 Ft	Width:	125 Ft			
Slabs:		Slab Length:	Ft	Slab Width:	Ft	Joint Length:	Ft	
Shoulder:		Street Type:		Grade:	0	Lanes:	0	
Section Comments:								
Work Date:	1/1/2021	Work Type:	New Construction - AC	Code:	NC-AC	Is Major M&R:	True	
Last Insp. Date:	10/14/2024	TotalSamples:	6	Surveyed:	3			
Conditions:	PCI: 94							
Inspection Comments:								
Sample Number:	02	Type:	R	Area:	6218.00 SqFt	PCI:	94	
Sample Comments:								
57	WEATHERING	L		6218.00 SqFt				
Sample Number:	04	Type:	R	Area:	6194.00 SqFt	PCI:	94	
Sample Comments:								
57	WEATHERING	L		6194.00 SqFt				
Sample Number:	06	Type:	R	Area:	7523.00 SqFt	PCI:	94	
Sample Comments:								
57	WEATHERING	L		7523.00 SqFt				